



**Russell**<sup>®</sup>  
By Rheem

PROJECT NAME \_\_\_\_\_  
LOCATION \_\_\_\_\_  
ARCHITECT \_\_\_\_\_  
ENGINEER \_\_\_\_\_  
CONTRACTOR \_\_\_\_\_  
SUBMITTED BY \_\_\_\_\_ DATE \_\_\_\_\_

**UNIT SUMMARY**

Quantity						
Unit Designation						
Model No.						
Total Cooling						
Sensible Cooling						
Air Ent. Evaporator						
Air Lvg. Evaporator						
Heating Input						
Heating Output						
CFM/ESP						
EER/SEER						
Electrical						
Minimum Ampacity						
Min.-Max. Breaker						
Net Unit Weight						
Accessory						
Catalog Form Number						

**ACCESSORIES:**

**NOTES:**

# Vantix™ Line RACBZR iR Packaged Air Conditioner

## Cooling Efficiencies up to: 13.4 SEER2

### Nominal Sizes: 2–5 Ton [7.03 kW–17.58 kW]

JOB NAME \_\_\_\_\_ LOCATION \_\_\_\_\_

CONTRACTOR \_\_\_\_\_ ORDER NO. \_\_\_\_\_

ENGINEER \_\_\_\_\_ UNIT MODEL NO. \_\_\_\_\_

SUBMITTED FOR  APPROVAL  RECORD COIL MODEL NO. \_\_\_\_\_

DATE \_\_\_\_\_ AIR HANDLER MODEL NO. \_\_\_\_\_

### UNIT DATA

#### COOLING PERFORMANCE

TOTAL CAPACITY\* ..... MBH

SENSIBLE CAPACITY\* ..... MBH

OUTDOOR DESIGN TEMP. ... °F [°C] DB/WB

TOTAL SUPPLY AIR ..... CFM [L/s]

TEMP. OF AIR ENTERING  
EVAPORATOR COIL ..... °F [°C] DB/WB

POWER INPUT REQUIREMENT ..... kW

SEER/EER RATING .....  
(\*uses blower motor heat)

#### ELECTRIC HEAT PERFORMANCE

ELECTRIC HEAT CAPACITY ..... kW

#### SUPPLY AIR BLOWER PERFORMANCE

TOTAL SUPPLY AIR ..... CFM [L/s]

TOTAL RESISTANCE EXTERNAL  
TO UNIT ..... IWG

BLOWER SPEED ..... RPM

POWER OUTPUT REQUIREMENT ..... BHP

MOTOR RATING ..... HP [W]

POWER INPUT REQUIREMENT ..... kW

#### ELECTRICAL DATA

POWER SUPPLY ..... / /

TOTAL UNIT AMPACITY ..... AMPS

MINIMUM WIRE SIZE ..... AWG

MAXIMUM OVERCURRENT DEVICE  
FUSES HACR BREAKER ..... AMPS

#### TOTAL UNIT WEIGHT

TOTAL OPERATING WEIGHT ..... LBS [kg]  
(including field-installed accessories)

#### CLEARANCES

FRONT	48" [1219 mm]
CONDENSER COIL	18" [457 mm]
DUCT SIDE	12" [305 mm]
EVAPORATOR END	36" [914 mm]
ABOVE UNIT	60" [1524 mm]

### UNIT DIMENSIONS FOR PACKAGE AIR CONDITIONERS 2 TO 5 TON [7.3 TO 17.6 kW] MODELS

#### DIMENSIONS

Model	Height "A"
024, 030, 036, 042	29 1/8"
048, 060	37 1/8"

#### FRONT VIEW

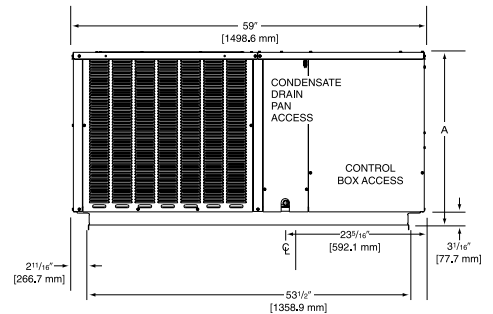

#### REAR VIEW

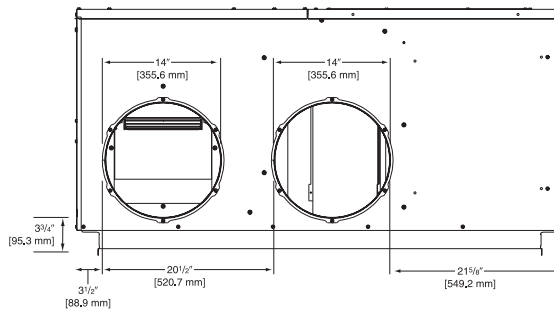

#### ELECTRICAL CONNECTIONS

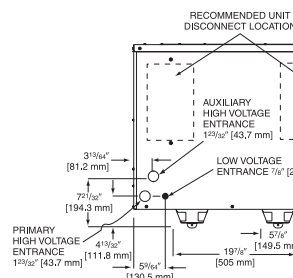

#### BOTTOM VIEW

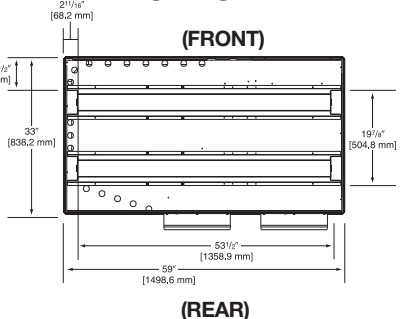

[ ] Designates Metric Conversions



## FRONT VIEW

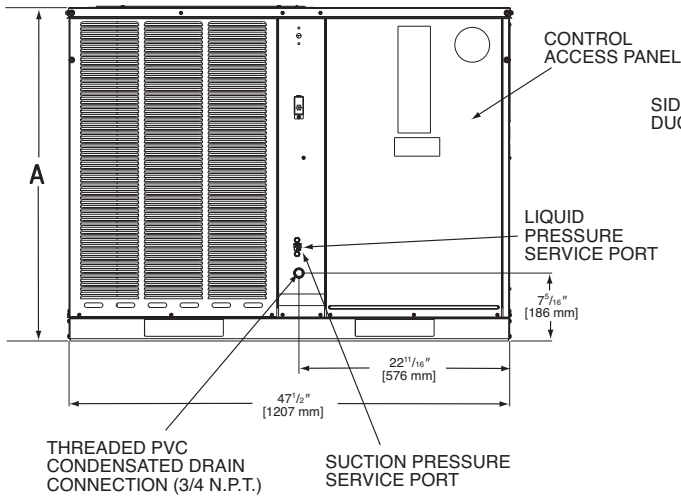

## REAR VIEW

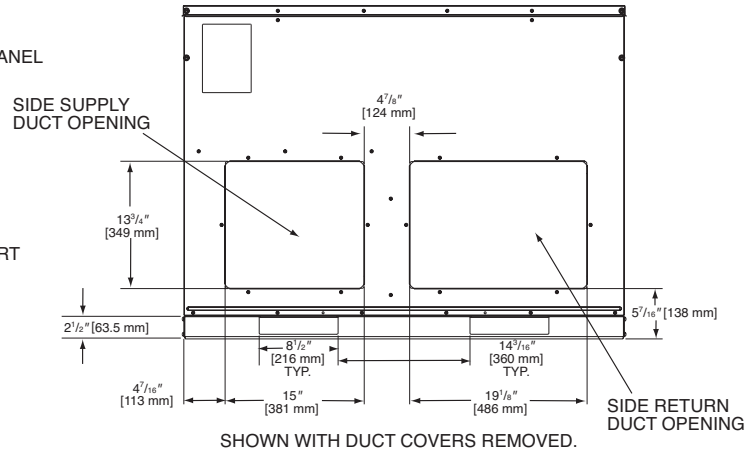

Model #	Height "A"
024, 030, 036, 042	35 15/16
048, 060	41

**IMPORTANT:**  
Unit must be level to  
prevent water migration.

[ ] Designates Metric Conversions

## FEATURES

### Performance

- Micro-channel refrigerant system – uses up to 58% less refrigerant than other models for superior heat transfer capabilities and better performance

### Installability

- Dedicated horizontal airflow<sup>1</sup>
- Single-point wiring – simplifies installation
- Zero-clearance capability – makes space-constrained installations easy

<sup>1</sup>RACBZR products are dedicated horizontal

### Serviceability

- Copper refrigerant connections – create a reliable and familiar braze joint
- Control box mounted refrigerant gauge ports for “tool required” service access
- Slide-out blower – makes removal easier

**Before proceeding with installation, refer to installation instructions packaged with each model, as well as complying with all Federal, State, Provincial, and Local codes, regulations, and practices.**

5600 Old Greenwood Road  
Fort Smith, Arkansas 72908

© 2023 Rheem Manufacturing Company. Russell By Rheem and Sure Comfort trademarks owned by Rheem Manufacturing Company.

“In keeping with its policy of continuous progress and product improvement, Rheem reserves the right to make changes without notice.”