



A Design So Smart—It's Simple.  
**RUUD® AIR CONDITIONERS  
& HEAT PUMPS**



 RELY ON RUUD.™

**We Thought of Everything... And Then Some.**

**We talked to a lot of dealers before we re-engineered our air conditioner and heat pump line. And, as a direct result, we were able to design a line so smart—it's simple. Our air conditioners and heat pumps are easier than ever to install, and troubleshooting and service calls have been simplified, too. From spacious corner access, to a new and improved composite base pan design, we have implemented your air conditioner and heat pump wish list to make your life easier.**

## 360° Performance®

The Ruud® air conditioner and heat pump platform was designed to provide substantially greater efficiencies in cooling and heating. Specifically, our cooling efficiencies are 54% higher than traditional designs and our heating efficiencies are 58% higher. The new inverter technology can modulate from 25% to over 200% of rated speed, while matching a heating load down to 0°F. The overdrive feature maintains your home's comfort when outside temperatures are as high as 107° F, making this platform one of the most precise systems available today. Dehumidification provided by this technology is amongst the best in its class. And a smart new composite base pan adds to the overall durability and quiet performance.



### PlusOne® Energy Efficiency

Our entire air conditioner and heat pump line delivers the solid technology and energy-saving performance both you and your customers have come to expect from Ruud. Our *Ultra™* Series air conditioners deliver a minimum of 20-SEER performance on all cooling capacities, and our heat pumps deliver a minimum of 13-HSPF heating efficiency on all capacities... And then some.

## 360° Integration®

EcoNet® is an innovative technology available exclusively from Ruud that monitors and controls Ruud heating, cooling and water heating systems, ensuring optimal performance and energy efficiencies in the home. The EcoNet Smart Thermostat features a modern, streamlined, customer-friendly user interface and includes features that make your job easier from installation through service.



## 360° Installability®

We've included features on our new air conditioners and heat pumps that make installation easier than ever, like the large 15"-wide control box that can be accessed by removing just two fasteners. Its size is unlike anything else in the industry and makes electrical connections a cinch. The new composite base pan is designed for an easy grip, and you're going to love the built-in service trays that conveniently hold screws and caps. The new base pan also includes integrated placement for CPVC stands that give you smart options for raising the unit above the snow line in northern climates.



### PlusOne® Expanded Valve Space

Our 3", 4" and 5" service valve space leads the industry with more work room between, below and above the service valves. You get an unprecedented 27 sq. in. work area for easier schrader access, brazing, gauge hook-up and valve opening.

## 360° Serviceability®

Everything about our air conditioners and heat pumps is service-friendly—from the easy-to-access external gauge ports, to an accessible fan motor with extra-long wires. The service window can be opened with the removal of two fasteners, giving quick access to the high and low pressure switches, while also allowing you to troubleshoot with the system still running. To speed up service calls even more, each unit comes with a QR code on the rating plate that provides a direct link to technical information on demand.



### PlusOne® Triple Service Access

Our air conditioner and heat pump platform delivers some of the most serviceable units on the market thanks to our **Triple Service Access**. The first point of access is our 15"-wide control box that opens by removing two fasteners. Second is the two-fastener removable corner allowing ideal access to the unit's internal components. And our single-fastener, quick-release louver panels provide a third access point, making coil cleaning easier than ever before.



## WHAT IS 360°+1?

For nearly a century, Ruud® has been an air industry leader, pioneering numerous industry firsts that meet the needs of homeowners and dealers. We consider the work that goes into installing and servicing our products as well as how we can deliver the best homeowner experience... And then some. That's 360°+1.

We engineered performance, innovation and everyday improvements into even the smallest details, resulting in three key product feature categories:

 **360° Performance®**  **360° Installability®**  **360° Serviceability®**  **360° Integration®**

We took it a step further and delivered PlusOne® advantages—unique Ruud innovations designed to make your job easier while providing homeowners with the ultimate home comfort experience.



**Achiever® Series  
Heat Pumps**  
RP14 / RP15 / RP16

**Achiever Plus® Series  
Heat Pumps**  
UP17

**Ultra™ Series  
Heat Pumps**  
UP20

**Ultra™ Series  
Air Conditioners**  
UA20

**Achiever® Series  
Air Conditioners**  
RA13 / RA14 / RA16

**Achiever® and Achiever Plus®  
Series¹ Air Conditioners**  
UA17

<sup>1</sup>Classic Plus Series is EcoNet®-Enabled. Classic Series is non communicating

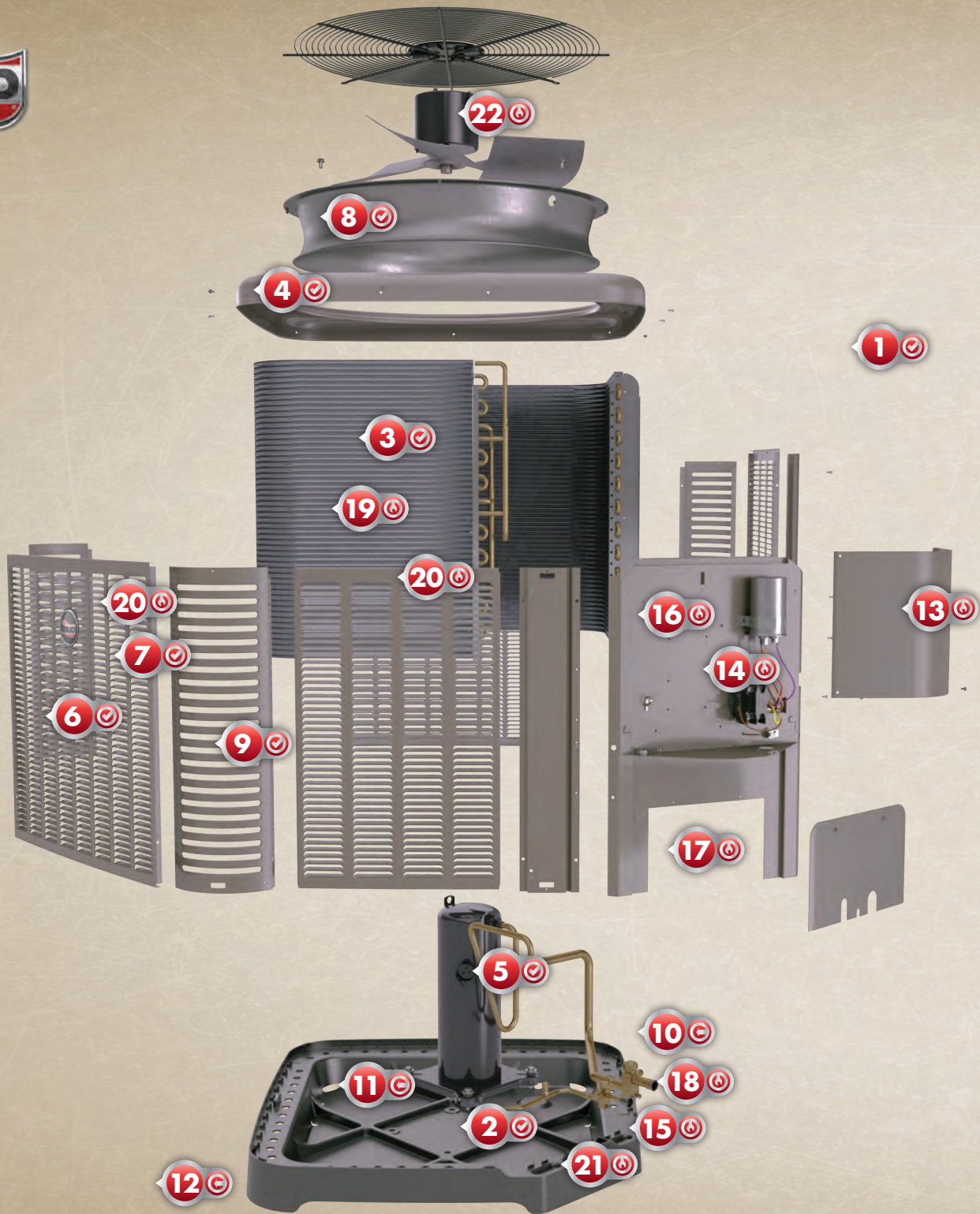



## 360° Performance®

- PlusOne® **Energy Efficiency (1)** – Our *Ultra™* Series air conditioners deliver up to 20 SEER performance on all cooling capacities and our *Ultra Series* heat pumps deliver up to 11-HSPF heating efficiency
- New composite base pan **(2)** – dampens sound, captures louver panels, eliminates corrosion and reduces number of fasteners needed
- Single-row condenser coils **(3)** – make unit lighter and easier to clean
- Powder coat paint system **(4)** – provides a long-lasting professional finish
- Scroll compressor **(5)** – uses 70% fewer moving parts for higher efficiency and increased reliability
- Modern cabinet aesthetics **(6)** – increase curb appeal with visually appealing design
- Curved louver panels **(7)** – provide ultimate coil protection, enhance cabinet strength and increase cabinet rigidity
- Optimized fan orifice **(8)** – optimizes airflow and reduces unit sound
- Optimized airflow patterns through corner venting **(9)** – protect coil while increasing uniform airflow
- Full line of 17-SEER heat pumps and 20-SEER air conditioner / heat pump inverter-driven products – matches comfort needs precisely and provides greater dehumidification
- Commercial grade electronic expansion valves<sup>1</sup> – increase system performance using proprietary software algorithms to control
- Improved tubing design – reduces vibration and stress, making unit quieter and reducing opportunity for leaks
- Optimized defrost characteristics<sup>2</sup> – decrease defrosting and provide better home comfort
- Optimized reversing valve sizing<sup>2</sup> – improves shifting performance for quieter unit operation and increased life of the system
- Enhanced mufflers<sup>2</sup> – help to dissipate vibration energy, for quieter unit operation



## 360° Installability®

- PlusOne® **Expanded Valve Space (10)** – 3", 4" and 5" service valve space – provides a minimum working area of 27 sq. in. for easier access
- Integrated heat pump lift receptacle **(11)** – allows standard CPVC stands to be inserted into the base
- Optimized product footprint **(12)** – reduces installation hassles
- Rust-resistant screws – confirmed through 1500-hour salt spray testing
- 4-wire installation<sup>3</sup> – makes for a faster and hassle-free installation
- EcoNet® auto-configuration<sup>3</sup> – automatically configures system airflow to optimal levels, making system set-up hassle-free<sup>2</sup>



## 360° Serviceability®

- Easy control box access **(13)** – makes access to critical service components faster with two-fastener removal
- 1.5"-wide control box **(14)** – allows for easy electrical hookup
- Easily accessible gauge ports on composite base pan **(15)** – make service easier
- PlusOne® **Triple Service Access (16)** – 1.5"-wide, industry-leading corner service access makes repairs easier and faster. The two-fastener removable corner allows optimal access to internal unit components. Individual louver panels come out once fastener is removed for faster coil cleaning and easier cabinet reassembly
- Diagnostic service window with two-fastener opening **(17)** – provides access to high and low pressure TXV valves and the heat pump reversing valve before opening the unit
- External gauge port access **(18)** – allows easy connection of "low-loss" gauge ports
- Single-row condenser coil **(19)** – allows thorough coil cleaning to maintain "out-of-the-box" performance
- 35% fewer cabinet fasteners and fastener-free base **(20)** – allow for faster access to internal components and hassle-free panel removal
- Service trays **(21)** – hold fasteners or caps during service calls
- Fan motor harness with extra-long wires **(22)** – allows unit top to be removed without disconnecting fan wire
- 60 points of diagnostics with EcoNet system<sup>3</sup> – provides extensive diagnostic information and eliminates repair guesswork
- QR code – provides technical information on demand for faster service calls
- Optimized internal component placement and orientation – improves access to key components for faster repairs and change-outs

<sup>1</sup>Applies to inverter systems only <sup>2</sup>Applies to heat pumps only <sup>3</sup>EcoNet-Enabled models only, not applicable for Achiever® Series models



## WHY RUUD?

### Partnership, Dedication and Innovation

Ruud® makes customers its first priority, with an approach to keep the dialogue going and to listen. Then act. The advancements Ruud has offered throughout the years in both the heating, cooling and water heating industries are a direct result of that process—and there is a long list of industry firsts to show for it, with more to come. Ruud is dedicated to providing the products your customers need and the opportunities you want to expand your offerings and increase profitability. That's the Ruud 360°+1 approach to partnership.



Learn more at [MyRuud.com/360](https://www.MyRuud.com/360)

*In keeping with its policy of continuous progress and product improvement, Ruud reserves the right to make changes without notice.*

Ruud Heating, Cooling & Water Heating • 5600 Old Greenwood Road  
Fort Smith, Arkansas, 72908

Ruud Canada Ltd./Ltée • 125 Edgeware Road, Unit 1  
Brampton, Ontario • L6Y 05P